

FILTER OVERVIEW WITH SERVICE INTERVALS AND CAPACITIES

M4030 / M4040 Self-Propelled Sprayers

CAB AIR FILTER RECIRCULATION

ACTIVATED CARBON - [RE199682](#)
Replace after every 500 hours or annually,
whichever occurs first and as required.



CAB AIR FILTER

ACTIVATED CARBON - [RE199681](#)
Replace after every 500 hours or
annually, whichever occurs first and
as required.



ON BOARD AIR (OBA)

**AIR DRYER CARTRIDGE -
[AN204967](#)**
Replace annually.



HYDRAULIC SYSTEM

HYDRAULIC FILTER - [AN203010](#)

Change after 500 hours.

(Click here for [capacity](#))



HYDROSTATIC SYSTEM

OIL FILTER - [AN203010](#)

Change after 500 hours.

(Click here for [capacity](#))



ENGINE

OIL FILTER - [RE504836](#)

Replace after first 100 hours then after first 500 hours
and every 500 hours thereafter. The extended 500 hour
interval is only allowed if using Plus-50™ II oil, JD OEM
Oil Filter and diesel fuel with sulfur content less than
15mg/kg (15 ppm).

(Click here for [capacity](#))

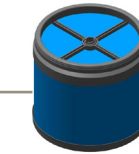

ENGINE

**PRIMARY AIR FILTER -
[RE196945](#)**

Change as needed, or if the
restriction indicator is on.

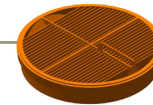

ENGINE

**SECONDARY AIR FILTER -
[RE181915](#)**

Change every second exchange
of the primary air filter.



WATER SEPARATOR

**FILTERING ELEMENT -
[RE541922](#)**

Replace annually.



ENGINE

FUEL FILTER - [RE522878](#)

Replace after every 500 hours.



JOHN DEERE

Genuine Parts and Service

CAPACITIES

M4030 / M4040 Self-Propelled Sprayers

CAPACITIES (Approximate):

Fuel Tank:

..... 503 L (133 gal)

Cooling System with Heater: Cool-Gard™ II

..... 29.7 L (7.85 gal)

Crankcase including Filter: Plus-50™ II

..... 26 L (6.87 gal)

Hydraulic Reservoir: Torq-Gard™ Supreme

..... 62 L (16.4 gal)

Hydraulic System:

Torq-Gard™ Supreme

..... 122 L (32.2 gal)

Final Drives (Front Hubs) Each:

GL-5

..... 1.2 L (0.32 gal)

Final Drives (Rear Hubs) Each:

GL-5

M4030..... 1.2 L (0.32 gal)

M4040..... 1.5 L (0.39 gal)

[Return to Filter Overview](#)

